

RED TOP PLAZA LEASING PLAN

1300-1440 S. Milwaukee Ave., Libertyville, IL 60048

For information: **Luke Sementa**

E: lsementa@sterlingorganization.com

P: 855-505-7239

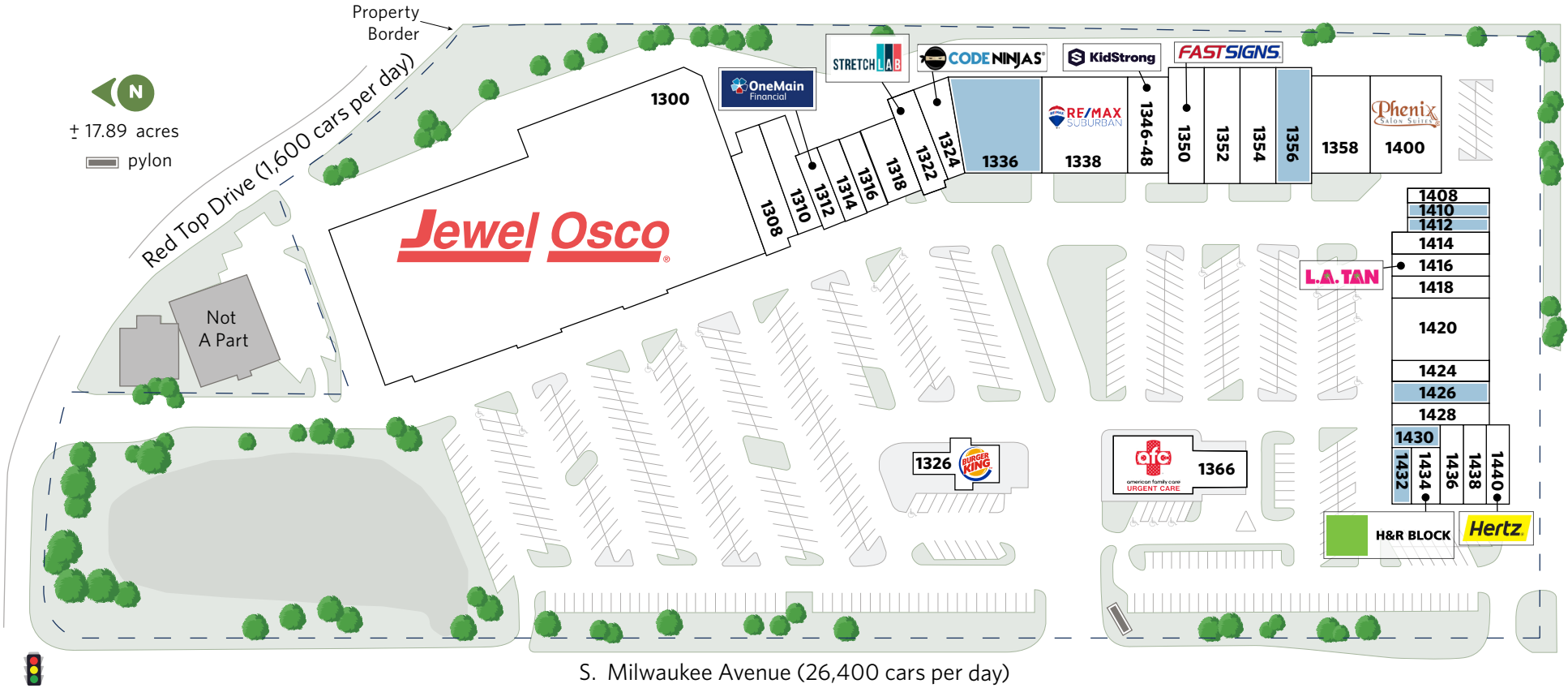

UNIT	TENANT	SQ. FT.	UNIT	TENANT	SQ. FT.	UNIT	TENANT	SQ. FT.	UNIT	TENANT	SQ. FT.
1300	Jewel Osco	66,844	1338	RE/MAX Suburban	6,400	1412	Available	1,200	1432	Available	800
1308	Vision Care	2,760	1346-48	KidStrong	3,200	1414	Studio Elevate Fit	1,600	1434	H&R Block	1,200
1310	Massage Motu & Chiropractic	3,000	1350	Fast Signs	2,500	1416	L.A. Tan	1,600	1436	Lou Malnati's Pizzeria	1,300
1312	OneMain Financial	1,200	1352	Athletico Physical Therapy	2,500	1418	Great Lakes Dental	1,600	1438	Max's Dawg House	1,300
1314	Warhammer	1,200	1354	Ki Martial Arts	2,500	1420	Plato's Closet	3,200	1440	Hertz	1,300
1316	Asurion Tech Repair & Solutions	1,200	1356	Available	2,500	1424	Slider Station	1,600	1326	Burger King	3,000
1318	Hunan Palace	2,400	1358	Foss Swim School	5,205	1426	Available	1,600	1366	AFC Urgent Care	4,000
1322	StretchLab	1,600	1400	Phenix Salon Suites	7,595	1428	La Mera Mera Taqueria	1,600	Total Square Feet: 151,840		
1324	Code Ninjas	2,736	1408	Nails First	1,200	1430	Available	800			
1336	Available	6,400	1410	Available	1,200						