

PHOENIX, AZ

18808 N. 32ND STREET

Phoenix, AZ 85050



☐ PHOENIX, AZ

18808 N. 32ND STREET

Phoenix, AZ 85050



STERLING
ORGANIZATION

For information: **John Lydon** E: john.lydon@am.jll.com P: 855-436-0611

June 2023

PHOENIX, AZ

18808 N. 32ND STREET

Phoenix, AZ 85050

UNIT	TENANT	SQ. FT.
1888	National Electric Vehicle Company	39,306

Total Square Feet: 39,306

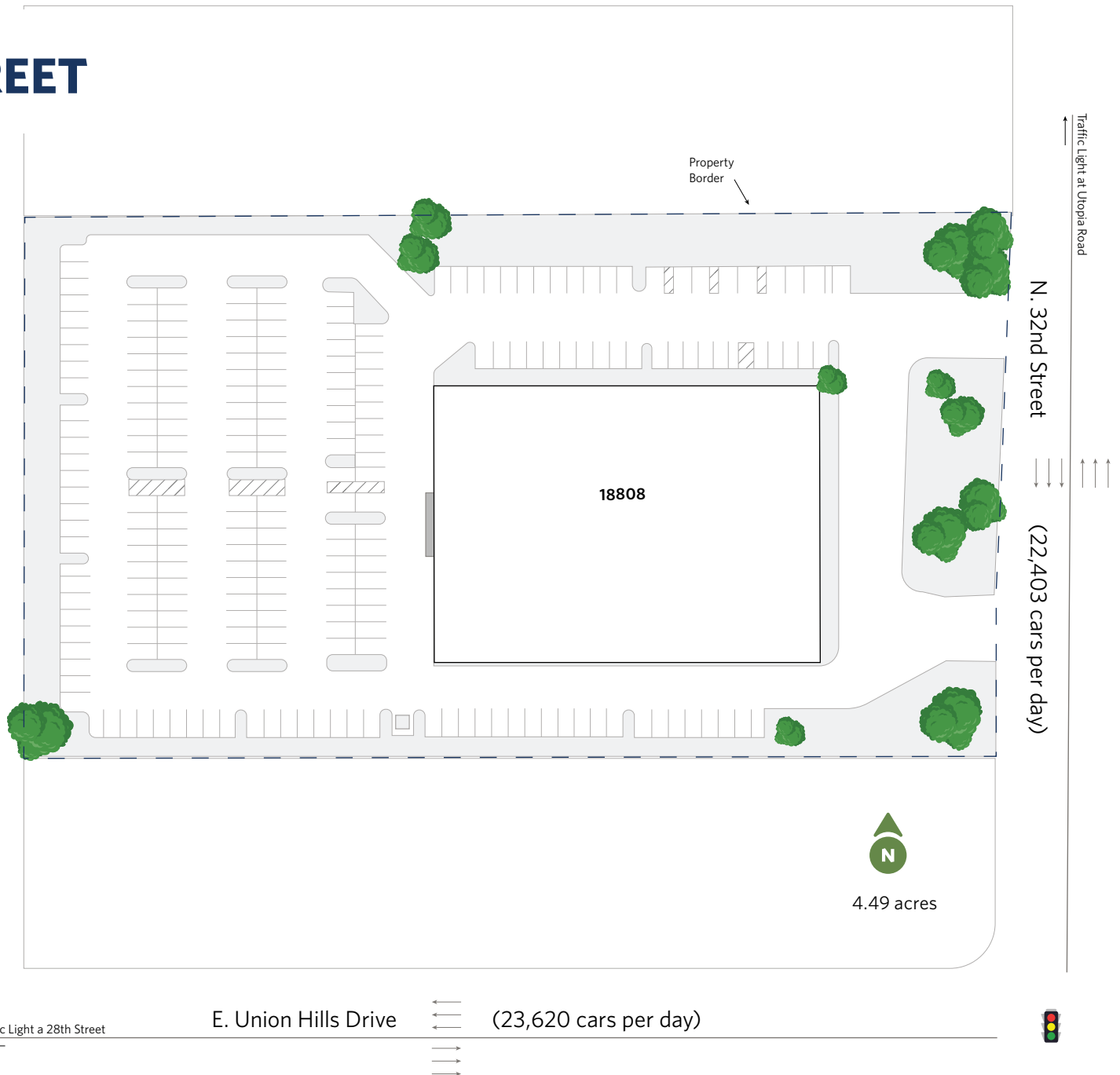

For information: John Lydon E: john.lydon@am.jll.com P: 855-436-0611



The plan and its contents are furnished for informational purposes only and are intended only as a general description (but not represented, covenanted or warranted). The size and location of the project, the identity or nature of any occupant and all features, matters and other information included herein are subject to change without notice and should not be relied upon by any party. No representation or warranty, express or implied, is made as to the accuracy or reliability of this plan or its contents.

18808 N. 32ND STREET

Phoenix, AZ 85050

DEMOGRAPHICS*			
DRIVE TIME	15 MIN.	30 MIN.	45 MIN.
Population:	504,987	2,102,410	3,925,056
Avg. HH Income:	\$105,370	\$93,772	\$92,781
Median HH Income:	\$76,053	\$64,073	\$66,679
Bachelor's Degree & Above:	43.3%	35.6%	33.6%
Annual Retail Goods Spending:	\$5,706,753,850	\$19,734,154,573	\$34,894,985,675
Annual Online Retail Sales Est.:	\$993,573,639	\$3,172,511,262	\$5,636,812,937
Online Retail (%):	17.41%	16.08%	16.15%

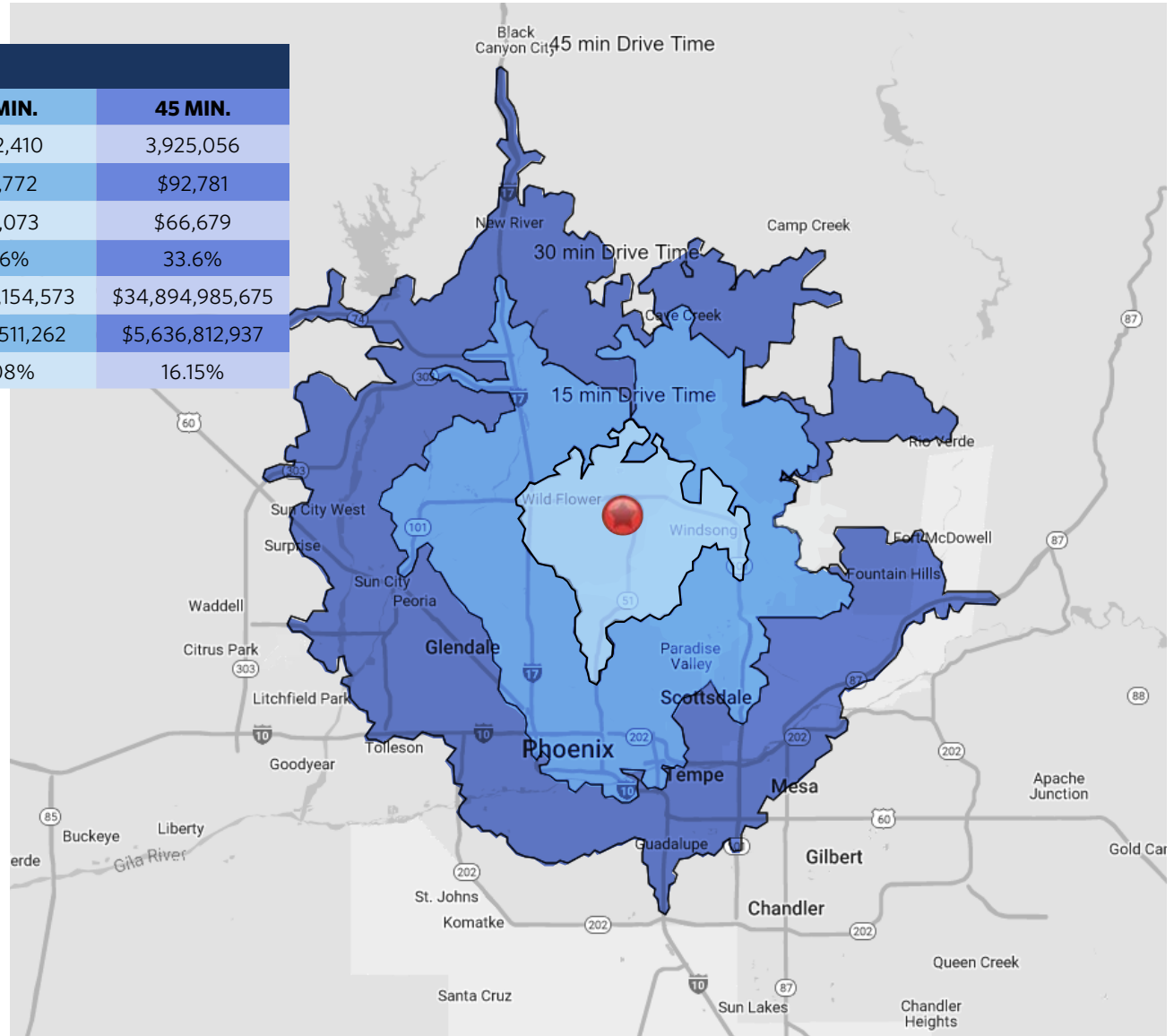

*Source: ESRI.