

VILLAGE AT STONE OAK

22610 US Hwy 281 N,
San Antonio, TX 78258

CRAFTED FOR CONNECTION



For information:

Deirdre Delaporte

E: ddelaporte@sterlingorganization.com

P: 855-982-1213



STERLING
ORGANIZATION

villageatstoneoak.com

ACTIVATION AREAS



1 Alamo Drafthouse
Connection

5 Craft Brew Plaza

2 North Plaza

6 Shake Shack

3 New Gateway

4 Village Center



1 Alamo Drafthouse Connection

2 North Plaza

A: Improved stair and walkway connection for cinema patrons

B: New Landmark provides strong identity and wayfinding

C: Instagrammable backdrop and anchor for small plaza



For information:

Deirdre Delaporte

E: ddelaporte@sterlingorganization.com

P: 855-982-1213



STERLING
ORGANIZATION

villageatstoneoak.com

3 New Gateway

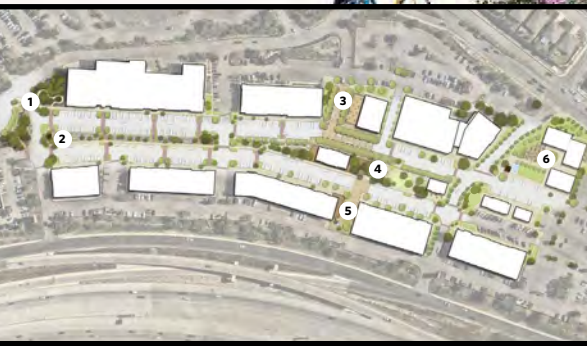

For information:
Deirdre Delaporte

E: ddelaporte@sterlingorganization.com
P: 855-982-1213



villageatstoneoak.com

4 Village Center



For information:
Deirdre Delaporte

E: ddelaporte@sterlingorganization.com
P: 855-982-1213



villageatstoneoak.com

5 Craft Brew Plaza



For information:

Deirdre Delaporte

E: ddelaporte@sterlingorganization.com

P: 855-982-1213



STERLING
ORGANIZATION

6 Shake Shack



For information:
Deirdre Delaporte

E: ddelaporte@sterlingorganization.com
P: 855-982-1213



PEDESTRIAN CROSSING AREAS

The pedestrian crossings are intended to work as intentional connectors, not just places to get through.

The central spine shifts from a straight corridor into a walkable, meandering path.

It's designed to support both movement and moments, places to walk, pause and gather. Scale, rhythm, and edge activation are all being refined.

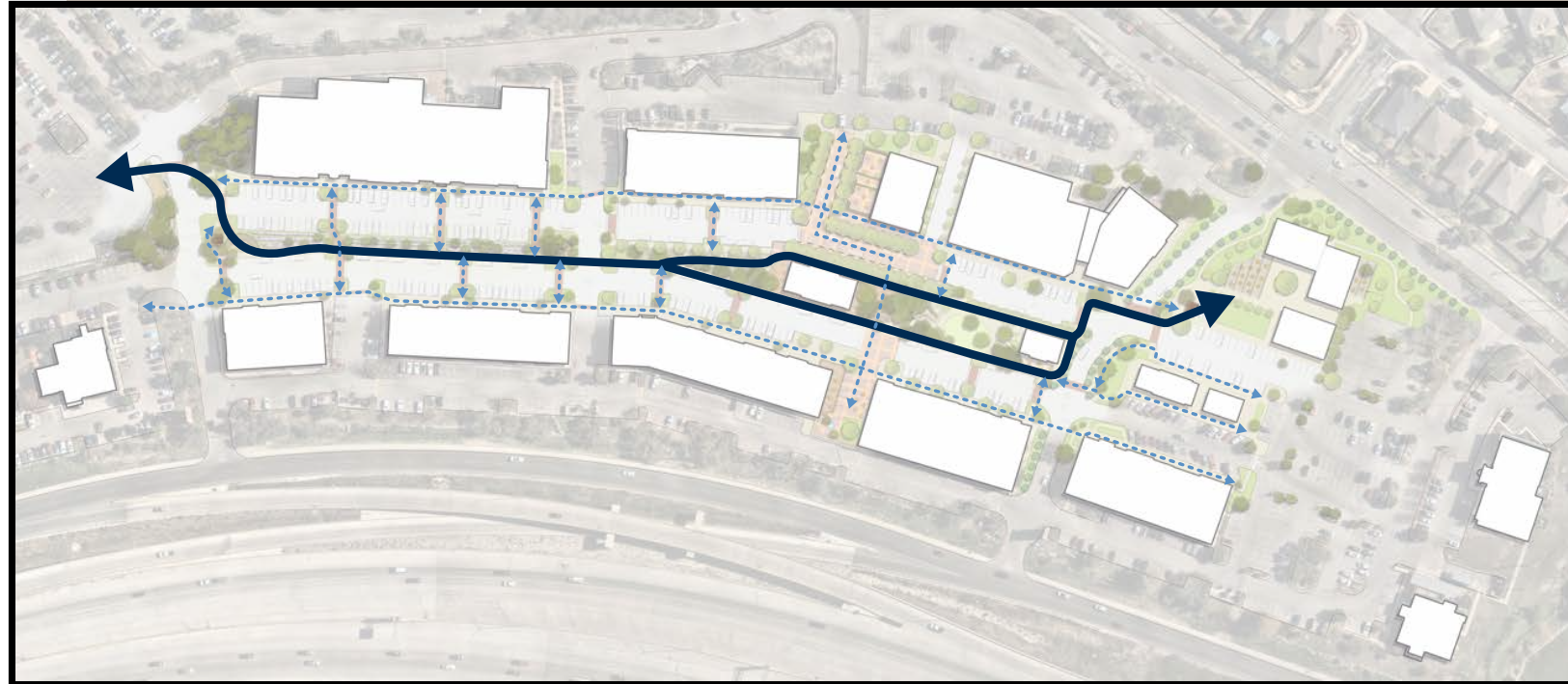

- Central Pedestrian Walk
- ... Secondary Pedestrian Walk

VILLAGE AT STONE OAK

22610 US Hwy 281 N, San Antonio, TX 78258

UNIT	TENANT	SQ. FT.	UNIT	TENANT	SQ. FT.	UNIT	TENANT	SQ. FT.	UNIT	TENANT	SQ. FT.
1	Hobby Lobby	55,000	140	Aqua Tots	5,558	H-20	Available	4,085	OFFICE		
5	Spec's Wines, Spirits & Finer Foods	12,134	145	Planet Party	4,000	H-35	Available	4,300	201	Schatz Orthodontics	1,804
10	Dollar Tree	10,000	160	Chili's Grill & Bar	5,867	I-01	Spectrum	4,000	204	Klove Engineering	2,165
10B	Available	8,050	170	BJ's Restaurant and Brewhouse	7,787	I-05	Available	2,000	205	Elevate Architecture	983
15	HomeGoods	30,000	A-01	Available	3,670	I-10	Francesca's Collections	1,400	206	Ivy League Nurse Concierge	1,000
20	Petco	12,237	A-02	Available	3,283	I-15	Available	3,086	210	Troy L. Jones	2,286
35	Majestic Nail Lounge	2,939	A-03	Available	3,679	I-20	Carranza Jewelers	1,670	211	Gameday Men's Health	1,542
40	Kirkland's	7,000	B-01	Popshelf	12,000	I-23	Available	1,730	212	Northside Family Counseling Center (Coming Soon)	1,742
45	Ross Dress For Less	21,999	B-10	Pure Posh Salon	5,000	I-25	Chico's	5,005	214	Available	1,542
50	DSW Shoe Warehouse	15,000	B-15	Haus of Wellness and Aesthetics	2,766	J-01	Available	6,500	215	Management Office	1,500
60	GameStop	2,000	B-20	Available	8,761	J-05	Torrid	3,400	216	Available	1,300
65	Available	2,022	C-01	Available	6,650	J-10A	Strong Pilates	4,224	218	Microshare	1,200
68	Sport Clips	1,539	D-01	Talbots	6,000	J-10B	Available	243	219	Fantastic Sams	1,088
O-1	Impact Urgent Care	5,567	D-10	Stone Creek Jeweler	900	J-15	Available	2,400	220	Available	1,041
O-15	Available	2,000	D-15	Victoria's Secret	8,000	J-17	Available	800	221	The Quenedit Ballet School	6,000
O-16	Sola Salon Studios	6,025	D-30	White House Black Market	3,305	J-20	Available	1,745	Office Square Feet: 25,193		
O-22	Red Wing Shoes	1,800	E-01	Alamo Drafthouse Cinema	27,000	K-01	La Bikini	2,000	Total Square Feet: 476,311		
O-25	MyEyeDr.	2,150	E-10	Ulta Beauty	10,391	K-02	Shear Madness	1,654			
F-1	54th Street Bar & Grill	6,400	E-20	Available	2,200	K-03	CPR Cell Phone Repair	1,200			
80	Available	1,864	E-25	Bath & Body Works	3,300	K-05	Available	4,921			
81	Image Studios	5,103	E-30	Lovely Brows	706	K-10	Hand & Stone Massage and Facial Spa	2,900			
90	TPC Dental Care	2,200	E-35	Four 9 Cigars	1,800	K-15	AT&T	3,600			
91	TPC Nail Salon and Spa	1,600	G-01	Stout House	3,200	L-01	Bakudan Ramen	2,503			
95	Airrosti	2,000	G-05	Available	1,874	L-10	Marble Slab Creamery	1,400			
100	Subway	1,500	G-10	Grimaldi's Pizzeria	4,601	M-01	Starbucks	1,700			
105	Available	2,588	H-01	James Avery	2,800	N-01	Playa Bowl	1,000			
110	Uptown Cheapskate (Coming Soon)	6,000	H-10	Studio Nails & Spa	1,315	N-05	Claire's	1,600			
125	Prestige Barbershop (Coming Soon)	1,190	H-15	Available	3,000	N-10	Brighton Collectibles	1,000			
130	Available	1,190									



For information:
Deirdre Delaporte

E: ddelaporte@sterlingorganization.com
P: 855-982-1213

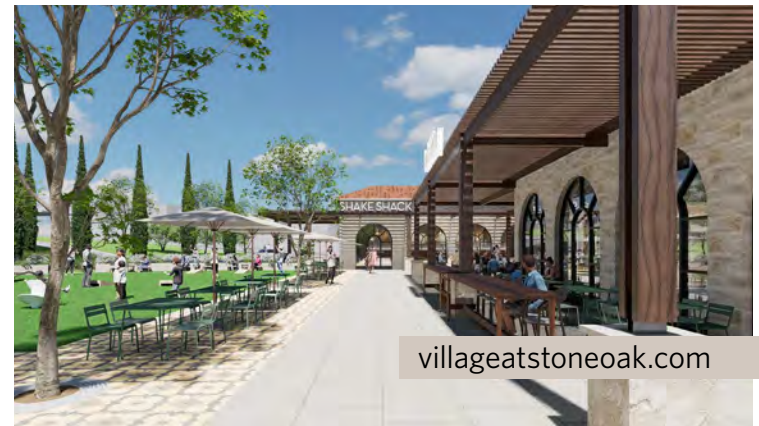

villageatstoneoak.com

DEMOGRAPHICS

1 MILE

Population: 8,909

Average Household Income: \$162,939

Median Household Income: \$114,373

3 MILE

Population: 83,843

Average Household Income: \$170,625

Median Household Income: \$117,893

5 MILE

Population: 172,744

Average Household Income: \$162,823

Median Household Income: \$111,941

